

HW320MS



Coral's 2" Thick Series HW320MS and HW520WS entrance systems are engineered for durability. Resolute strength is delivered by the compliment of heavy-wall door, frame, and hardware for areas where extra heavy use and high traffic, command resilient performance and durability.

FEATURES and OPTIONS

- Stiles, Rails, & Door-frame components bolstered with 3/16" & 1/4" walls
- Available in Medium (3-3/4") & Wide stile (5")
- FL300HW (2"x4-1/2") Door-frame options
- Compatible with all Coral Curtain Wall and Storefront framing Systems
- 1/4" & 1" Glazing options
- 7-1/2" & 9-1/2" Bottom Rails
- Limited Lifetime Door Corner Construction Warranty
- Door Opening Size Up to 4'-0" x 8'-0"
- Fully Tested at Design Pressures of +65 / -65 & TAS202 Air & Static Test Standards
- FBC - Florida Product approval # FL20093
- Standard Anodize Finishes
- Standard and Custom Match AAMA 2604 & AAMA 2605 Powder Coat

HW320MS

HW320MS DETAILS

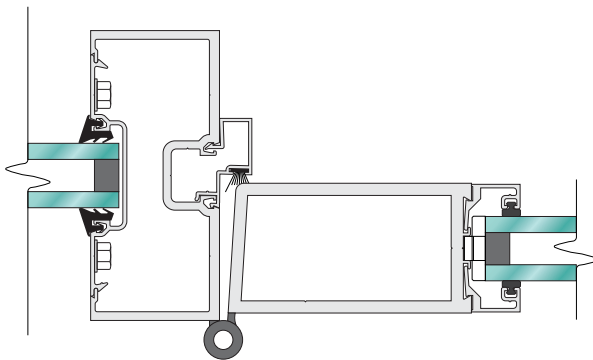
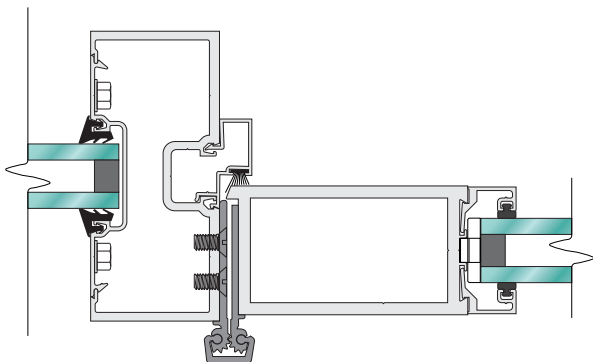
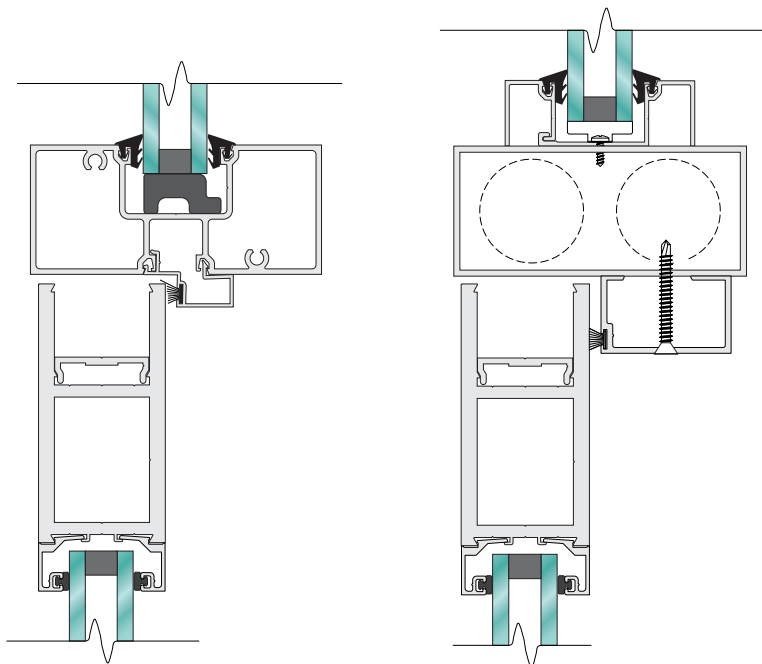

Additional Features, Options, and Hardware

- HW520 Wide Stile series available
- Short Lead Times
- Mid-rails: 4", 7-1/2" and 9-1/2"
- Surface Mount and Concealed Overhead Closers
- Overhead Stops and Holders
- CVR and Rim Panic Exit Devices
- Standard and Custom Push - Pulls
- Heavy Duty:
 - Continuous Geared hinge
 - Butt Hinges
- Electric Access Hardware
- Floor Closers
- Integral 3 point Lock
- Top and Bottom Flush Bolts (inactive leaf of pair)