

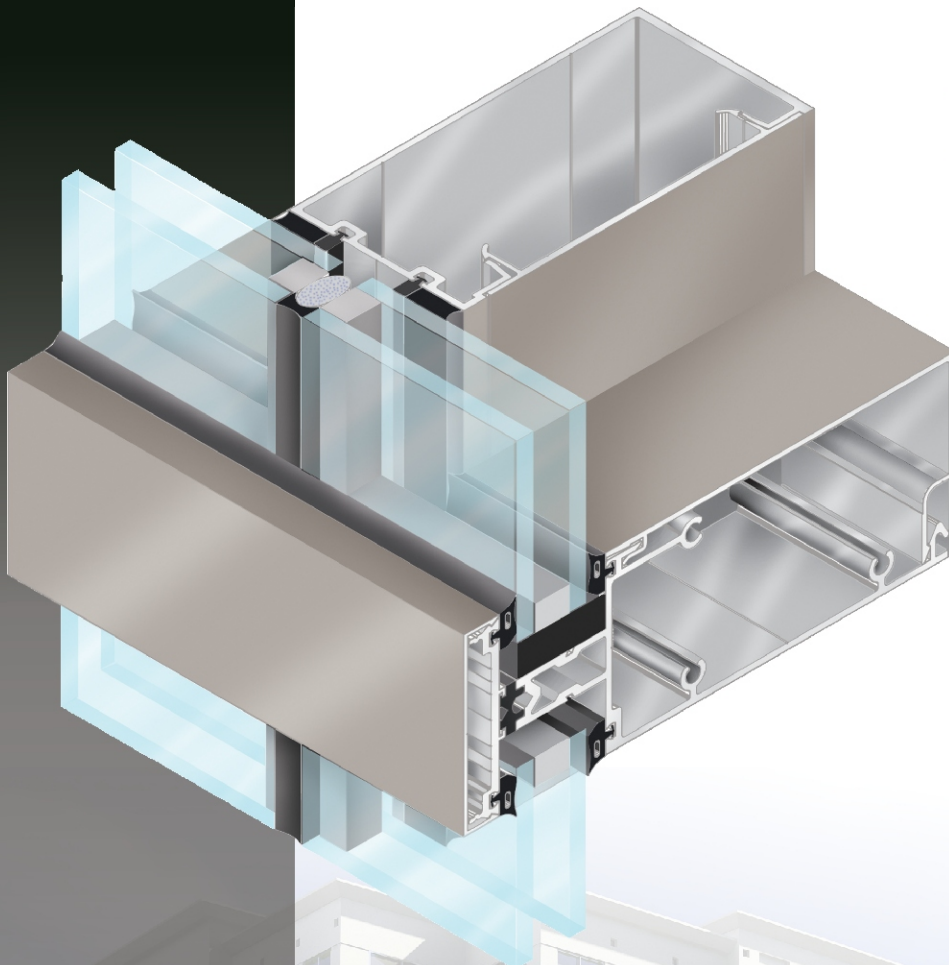

Curtain Wall

GLAZING SYSTEM



PW251 Butt Glazed System

- Air Infiltration at
6.24 PSF < .06 CFM
- Uniform Load Deflection
Test at +/-60 PSF
- Water at 20 PSF
- Uniform Load Structural
Test at +/- 90 PSF

PW251

BUTT GLAZED

CURTAIN WALL SYSTEM • 1"



FRONT LINE
ALUMINUM SYSTEMS

Coral

Architectural Products





Curtain Wall

GLAZING SYSTEM

PW251

BUTT GLAZED

CURTAIN WALL SYSTEM • 1"

■ Glazing gaskets:

- Same EPDM dense gasket used on interior and exterior at glass

■ Screw spline joinery allows:

- CoraPunch die shop fabrication
- Die set punches spline and pressure bar weep holes
- Panelized frame assembly for easy transporting and installing

■ Pressure Bars:

- Preloaded with a dense EPDM thermal isolator at factory with attachment holes pre-punched 9" O.C.
- Attached to back members with #12-14 x 1-1/4" HWH #3 self-drilling fasteners

■ Removable snap-on interior trim covers at all horizontals allow:

- Anchor inspection to substrate after glazing
- Inspection and/or repair of critical joint seal areas after glazing

■ Injection molded plastic end dams and bridges at horizontals provide:

- Accurate and tight seals at intersection of vertical/horizontal joints
- Zone glazed system with weep holes for water control
- Weep holes

■ Injection molded plastic top and bottom vertical mullion caps:

- Accurate compression fit
- Provides continuous perimeter seal

■ Injection molded plastic temporary glazing retainer:

- Reduces labor
- Distributes uniform pressure on glass reducing risk of breaking glass
- Reusable for next project

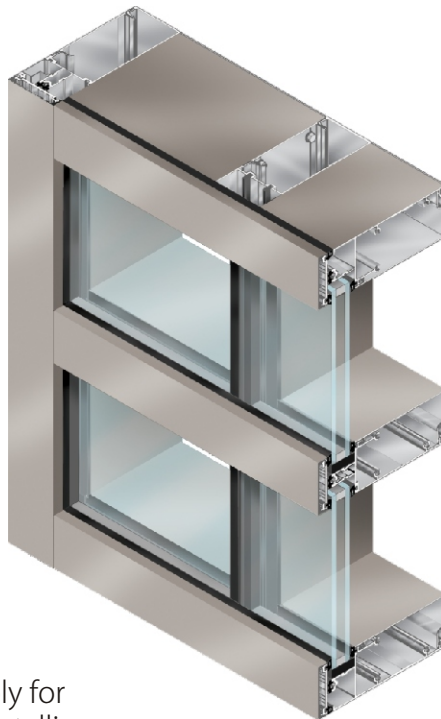

HEAD

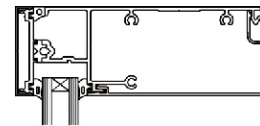

WALL JAMB

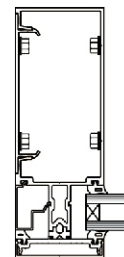

VERTICAL MULLION

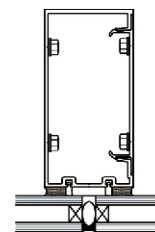

HORIZONTAL MULLION

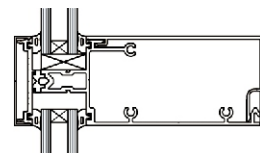

SILL

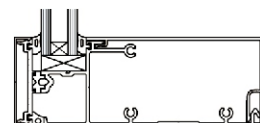

FRONT LINE
ALUMINUM SYSTEMS

Coral

■ Architectural Products ■

3010 Rice Mine Road ■ Tuscaloosa, AL 35406

1.800.772.7737 ■ Fax 1.800.443.6261 ■ www.coralind.com