

# Thermal Window Wall

## GLAZING SYSTEM

### Outside Glazed Performance

- **ASTM E330 - Structural**  
Design Pressure +35/-35 PSF  
Maximum DLO at Design Pressure = 46" x 72"  
Spans up to 8'-0" with maximum mullion spacing at 48" on center
- **ASTM E331 - Water**  
15 PSF
- **ASTM E283 - Air**  
@ 6.24 PSF < 0.060 cfm/ft<sup>2</sup>
- **AAMA 1503 - Thermal**  
U-Factor .46  
CRF 61

### Inside Glazed Performance

- **ASTM E330 - Structural**  
Design Pressure +55/-55 PSF  
Maximum DLO at Design Pressure = 46" x 92"  
Spans up to 8'-0" with maximum mullion spacing at 48" on center
- **ASTM E331 - Water**  
15 PSF
- **ASTM E283 - Air**  
@ 6.24 PSF < 0.060 cfm/ft<sup>2</sup>
- **AAMA 1503 - Thermal**  
U-Factor .46  
CRF 61

### FINISHES

- Architectural Class I and Class II Anodized finishes are available in stock colors.
- Architectural Powder Coat, the "green" choice, conforming to AAMA 2604 and AAMA 2605 are available in stock and custom match colors.

**Front Line FS400T** 2" x 4 1/2" Thermal Window Wall utilizes a continuous poured and debridged polyurethane thermal barrier.

# FS400T

**THERMAL WINDOW WALL SYSTEM • 1"**

**FRONT LINE**  
ALUMINUM SYSTEMS

*Coral*

▪ Architectural Products ▪

# Thermal Window Wall

## GLAZING SYSTEM

### FS400T

THERMAL WINDOW WALL SYSTEM • 1"

#### FEATURES

- 2" x 4 1/2" Profile for 1" glazing infill
- Top load EPDM gaskets
- Full complement of system designed parts and accessories
- Full height sub-sill
- Heavy wall mullion option without steel reinforcing
- Hydraulic CoraPunch or drill jig fabrication options
- Screw-spline joinery using #14 x 1" hex-head screws
- Deep pocket perimeter sections allow for:
  - Direct anchor attachment to substrate
  - Use of 1/4" diameter hex-head anchor bolts to substrate
- Deep pocket perimeter sections eliminate:
  - Drilling access holes
  - Blind caulk seals
- Fully tested for outside and inside glazing

#### HEAD

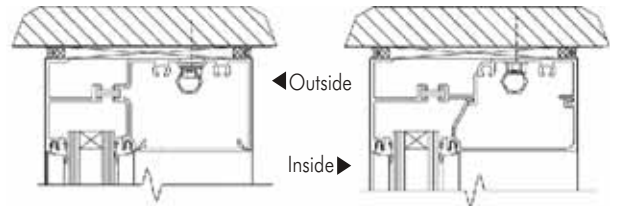

#### HORIZONTAL

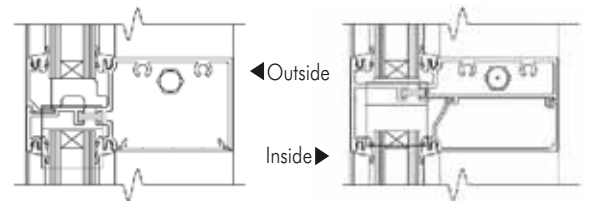

#### SILL

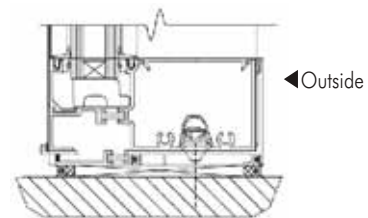

#### JAMB

#### VERTICAL STEEL REINFORCEMENT

#### VERTICAL

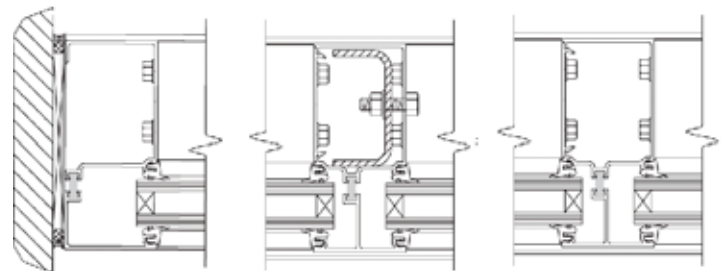

  
**FRONT LINE**  
ALUMINUM SYSTEMS

*Coral*

■ Architectural Products ■

3010 Rice Mine Road ■ Tuscaloosa, AL 35406

1.800.772.7737 ■ Fax 1.800.443.6261 ■ [www.coralind.com](http://www.coralind.com)